

**Use SharkBite® fittings for fast supply line to fixture connections.**

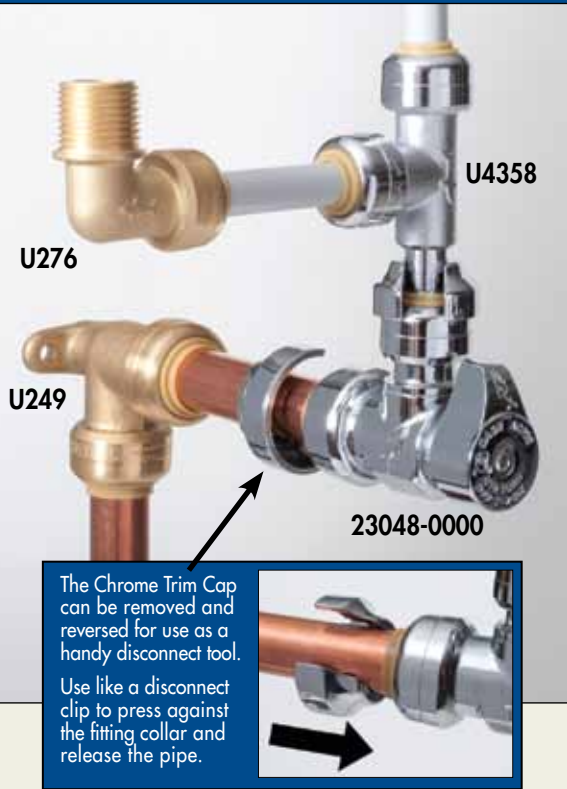

The Chrome Trim Cap can be removed and reversed for use as a handy disconnect tool. Use like a disconnect clip to press against the fitting collar and release the pipe.

**INSTALLATION AND DISCONNECTION**

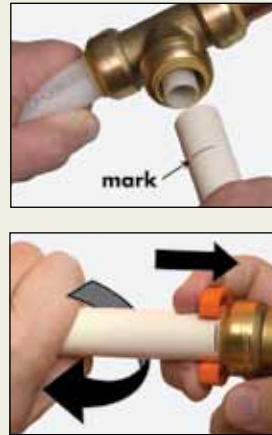

**EASY INSTALLATION**

Ensure the pipe is cut square, using the U702 tool – remove rough edges/debris and mark the pipe for depth. Push pipe and fitting together up to the depth mark.

**FAST DISASSEMBLY**

Using the simple disconnect tool, fittings can be easily changed and reused.

**CERTIFICATIONS**

The SharkBite® push-fit fittings have been design certified and listed to ASSE 1061/NSF 61. The SharkBite® push-fit fittings are listed by IAPMO and are certified for potable and hydronic heating water distribution (note: Glycol mixture for hydronics can be 100% concentration). The SharkBite® push-fit fittings have been certified for underground applications and as a manufactured joint without access panels and they meet UPC, IPC and cUPC requirements.

Please consult with local plumbing codes concerning specific applications.

The SharkBite® tubing without oxygen barrier is approved for all model codes in the US and Canada for use in potable water systems and is certified to the following standards: NSF 14/61, NSF P171, ASTM F 876, ASTM F 877, CSA B137.5 and AWWA C904.

The SharkBite® tubing with oxygen barrier is approved for use in all model codes in the US and Canada for use in hydronic and potable water systems and is certified to the following standards: NSF 14/61, NSF P171, ASTM F 876, ASTM F 877, CSA B137.5 and AWWA C904.

SharkBite PB Couplings are designed to work with ASTM D3309 spec polybutylene, do not install onto damaged or decayed PB pipe.

**SharkBite® PEX Tubing**

DIAMETER	LENGTH	P/N
1/4" (3/8" OD) Gray Color	5' straight 50' coil	U850G5 U850G50



Make your own risers using 1/4" (3/8" OD) SharkBite® PEX tubing. Then finish the supply line to fixture or appliance connections with SharkBite push-fit fittings and chrome stops.

**SharkBite® Fittings/Tube Size Compatibility**

Nominal Size of Fitting	Nominal Size of Tubing	Tubing OD Size	Tubing ID Size
1/4"	1/4" CTS	<b>3/8"</b>	0.305"
1/2"	1/2" CTS	<b>5/8"</b>	0.475"
1/4" compression	1/4" ACR	1/4"	0.190"
3/8" compression	3/8" ACR	3/8"	0.311"

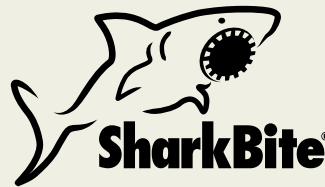

Distributed by Reliance Worldwide Corporation  
2100A Southbridge Parkway Suite 380  
Birmingham, Alabama 35209  
1-877-700-4242 or 1-205-803-4500 Fax: 1-205-870-7224

In Canada:  
1-888-820-0120 • FAX: 1-888-820-0121 • cashacme.ca

Product details at [sharkbitepro.com](http://sharkbitepro.com)

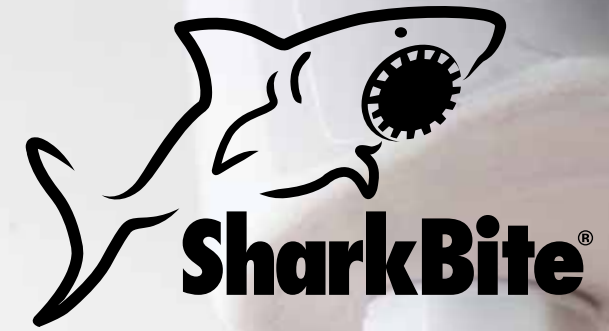

Now you can  
**make your own risers.**

Use 1/4" (3/8" OD) SharkBite® PEX tubing with SharkBite chrome fittings and stops for all supply-to-fixture connections.



**LIGHTNING FAST. WON'T LET GO.**

Attention: 1/4" SharkBite® fitting ends are for use with 1/4" CTS size (3/8" OD) PEX, CPVC or copper tubing.

## The SharkBite® Connection System now includes a complete range of 1/4" (3/8" OD) push-fit fittings and chrome plated stops.

Connecting supply lines to fixtures and appliances using these new SharkBite products brings the speed and convenience of push-fit connections



to the final phase of your plumbing jobs. Regular and chrome plated fittings are now available, including the newest 1/2" X 1/4" (3/8" OD)

SharkBite stop valves. Stops in 1/2" X 3/8" or 1/4" compression sizes are also available.

With these new SharkBite push-fittings, stop valves and the 5' lengths or 50' coils of 1/4" (3/8" OD) PEX tubing it's easy to make risers the exact length needed for connecting fixtures and appliances. No more problems with flexible lines that are too long or too short. Cut. Push. Done. It's easy with SharkBite.

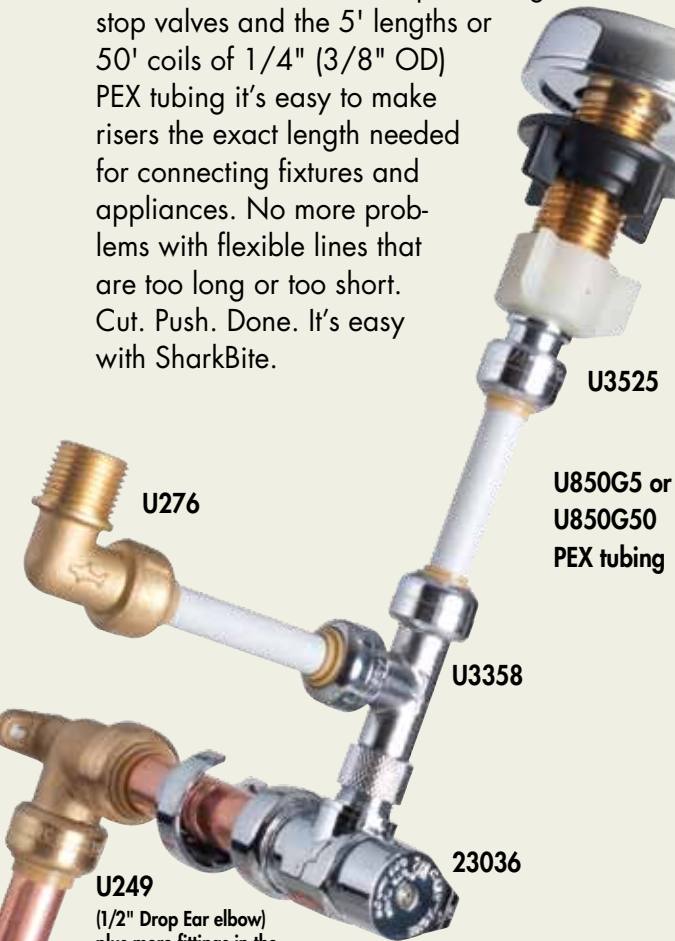

### Supply Stops & Fittings

#### Angle Stops, Quarter-Turn

SIZE**	P/N	P/N (Lead Free)
1/2" X 1/4" (3/8" OD)	23048	23048LF
1/2" X 3/8" comp	23036	23036LF
1/2" X 1/4" comp	23336	23336LF

#### Straight Stops, Quarter-Turn

1/2" X 1/4" (3/8" OD)	23049	23049LF
1/2" X 3/8" comp	23037	23037LF
1/2" X 1/4" comp	23337	23337LF

#### Stop Valve Tee Adapter

1/4" (3/8" OD) X 1/4" (3/8" OD) X 3/8" compression nut	U3358	U3358LF
1/4" (3/8" OD) X 1/4" (3/8" OD) X 1/4" CTS	U4358	U4358LF

#### Stop Valve Connector

1/4" (3/8" OD) X 3/8" compression nut	U3523	U3523LF
---------------------------------------	-------	---------

Converts 3/8" compression stop to SharkBite

#### Faucet Connector

1/4" (3/8" OD) X 1/2" Faucet	U3525	U3525LF
------------------------------	-------	---------

#### Toilet Connector

1/4" (3/8" OD) X Toilet Valve	U3531	U3531LF
-------------------------------	-------	---------

#### Toilet Elbow

1/4" (3/8" OD) X Toilet Valve	U3537	U3537LF
-------------------------------	-------	---------

### Couplings

#### Straight Couplings

SIZE**	P/N	P/N (Lead Free)
1/4" (3/8" OD) X 1/4" (3/8" OD)	U004	U004LF

### Connectors

#### Reducing Connectors

1/4" (3/8" OD) X 1/2" FNPT	U066	U066LF
1/4" (3/8" OD) X 1/2" MNPT	U110	U110LF

### Elbows

1/4" (3/8" OD)	U244	U244LF
----------------	------	--------

#### Dishwasher Elbow

1/4" (3/8" OD) X 3/8" MNPT	U276	U276LF
1/2" X 3/8" MNPT	U281	U281LF
1/4" (3/8" OD) X 3/4" GH	U2276	U2276LF

### Tees

1/4" (3/8" OD)	U358	U358LF
----------------	------	--------

#### Reducing Tee

1/2" X 1/2" X 1/4" (3/8" OD)	U359	U359LF
------------------------------	------	--------

### Tools

#### Disconnect Clip

1/4" (3/8" OD)	U706	-
----------------	------	---

#### Safe Seal Tool

1/4" 3/8" 1/2" 5/8" 3/4" 1"	U702	-
-----------------------------	------	---

\*\*Note: 1/4" push-fit connector ends require use of 3/8" OD CTS size PEX, CPVC or hard drawn Type K, L and M and annealed Type M copper complying with ASTM B 88. SharkBite® connector ends are not approved for use with chrome plated pipe. If it is necessary to use chrome plated tubing, the chrome finish should be completely removed from 1" of the tubing ends.

1-877-700-4242